

## 902/627 Victoria Street Abbotsford VIC

1 1

Lifestyle, Position, Convenience

Please note : This apartment does not come furnished, and does not have a car space.

With Victoria Gardens Shopping Centre opposite, Bridge Road/Swan Street eateries and boutiques close by, tram on your doorstep to the CBD in 15/20 minutes, The Park House is the ultimate lifestyle choice.

Features:

- Exquisite Location on the Banks of the Yarra River
- Superior Gaggenau Appliances
- Beautiful wide engineered Oak floors
- Sustainable 6+ Star Green Living Inside and Out
- World-Class Resident Amenities

**View** : <https://www.spaceea.com.au/lease/vic/inner-city/abbotsford/residential/apartment/7662427>

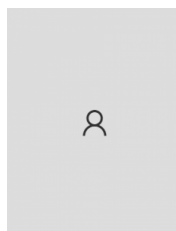

**Elias Karpathakis**

THE  
PARKHOUSE  
ABBOTSFORD

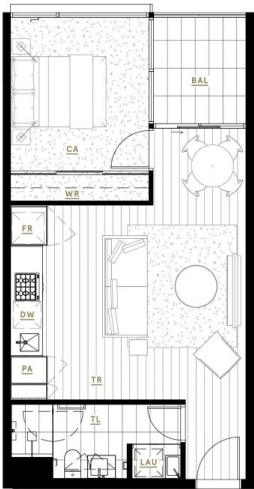

KEY

- PA Pantry
- FR Fridge/Freezer
- DW Dishwasher
- WR Wardrobe
- LAU Laundry
- BAL Balcony
- TR Timber Floor
- TL Tile Floor
- CA Carpet



APARTMENT TYPE

**A1.1** 1 Bed, 1 Bath

AREA

Internal	50.5m <sup>2</sup>	543ft <sup>2</sup>
External	5.2m <sup>2</sup>	56ft <sup>2</sup>
<b>Total</b>	<b>55.7m<sup>2</sup></b>	<b>599ft<sup>2</sup></b>

APARTMENTS

A302, A303, A402, A403, A502, A503, A602  
A603, A702, A703, A802, A803, A902, A903

RESIDENCE



LEVELS

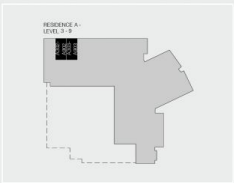

Disclaimer: All images, design features, views, photographs, diagrams and artist's impressions are for presentation purposes and are indicative only. Dimensions, areas, fittings and specifications are indicative and subject to change without notice. All internal/external furniture including study desks and planter boxes and whitegoods are not included in the price. Purchaser should check the plans and specifications in the terms of the contract of sale carefully prior to signing the contract.