



609/631 Victoria Street Abbotsford VIC

1 1

This East facing apartment is located across the road from Victoria Gardens Shopping Centre, with Bridge Road/Swan Street eateries and boutiques not far away.

View : <https://www.spaceea.com.au/lease/vic/inner-city/abbotsford/residential/apartment/7647198>

Apartment features include :

- Bedroom with large Built In Robes
- Superior kitchen with Gaggenau oven, gas stove top, and dishwasher
- Sleek bathroom
- Beautiful wide engineered Oak floors
- Sustainable 6+ Star Green Living Inside and Out
- World-Class Resident Amenities
- Exquisite Location on the Banks of the Yarra River
- Only a 15min tram ride to the Paris-end of Collins St



Joseph McCurry
03 9257 8788

Nestled in the bank of the Yarra , a mere 3km from the

THE
PARKHOUSE
 ABBOTSFORD



KEY

- PA Pantry
- FB Fridge/Freezer
- DW Dishwasher
- WR Wardrobe
- LAU Laundry
- BAL Balcony
- TR Timber Floor
- TL Tile Floor
- CA Carpet



APARTMENT TYPE

A10 1 Bed, 1 Bath

AREA

Internal	52.0m ²	559.7ft ²
External	6.5m ²	69.9ft ²
Total	58.5m²	629.6ft²

APARTMENTS

B109, B209, B309, B409, B509, B609, B709, B809, B909

RESIDENCE



LEVELS

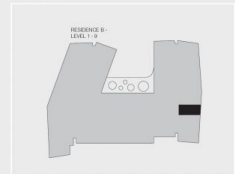

Disclaimer: All images, design features, views, photographs, diagrams and artist's impressions are for presentational purposes and are indicative only. Dimensions, areas, fittings and specifications are indicative and subject to change without notice. All internal/external furniture (including study desks and garden beds) and fittings are not included in the price. Purchaser should check the plans and specifications in the terms of the contract of sale carefully prior to signing the contract.