

802/627 Victoria Street Abbotsford VIC

1 1

* Subject to approval of a 12 month lease * Free rent will be two weeks off the first, and two weeks off the last month's rents *

** Net Effective Rent over 12 months = \$484 per week **

Eight Floor North Facing ParkHouse Apartment with River Views

With Victoria Gardens Shopping Centre opposite, Bridge Road/Swan Street eateries and boutiques close by, tram on your doorstep to the CBD in 15/20 minutes, The Park House is the ultimate lifestyle choice.

Features:

- Exquisite Location on the Banks of the Yarra River

View : <https://www.spaceea.com.au/lease/vic/inner-city/abbotsford/residential/apartment/7551538>



Joseph McCurry
03 9257 8788

THE
PARKHOUSE
ABBOTSFORD

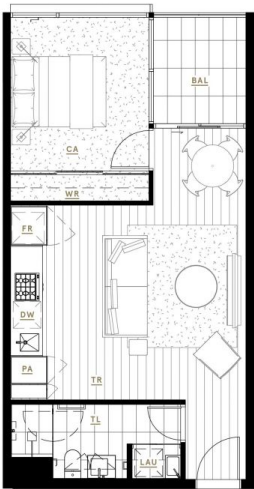

KEY

- PA Pantry
- FR Fridge/Freezer
- DW Dishwasher
- WR Wardrobe
- LAU Laundry
- BAL Balcony
- TR Timber Floor
- TL Tile Floor
- CA Carpet



APARTMENT TYPE

A1.1 1 Bed, 1 Bath

AREA

Internal	50.5m ²	543ft ²
External	5.2m ²	56ft ²
Total	55.7m²	599ft²

APARTMENTS

A302, A303, A402, A403, A502, A503, A602
A603, A702, A703, A802, A803, A902, A903

RESIDENCE



LEVELS

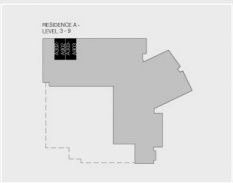

Disclaimer: All images, design features, views, photographs, diagrams and artist's impressions are for presentation purposes and are indicative only. Dimensions, area, fittings and specifications are indicative and subject to change without notice. All internal/external furniture including study desks and planter boxes and whitegoods are not included in the price. Purchaser should check the plans and specifications in the terms of the contract of sale carefully prior to signing the contract.