

**B709/609 Victoria Street Abbotsford VIC**

1 1 1

This one bedroom Green Square apartment with car space (not stacker) features :

- Sun-filled living
- Kitchen with stone bench tops and stainless Euro appliances including dishwasher
- Bedroom with built in robes
- Secure basement car park with storage cage
- Access to the fully equipped gymnasium, heated pool and sauna

Conveniently located with the city tram at your doorstep, and Victoria Gardens shopping complex just around the corner.

Book to inspect, enquire online or email [annabel.kotz@spaceea.com.au](mailto:annabel.kotz@spaceea.com.au) for more information.

**View :** <https://www.spaceea.com.au/lease/vic/inner-city/abbotsford/residential/apartment/7547075>

# Type 57

## 1 Bedroom & 1 Bathroom

Areas	
Apartment	49.8m <sup>2</sup>
Balcony	11.5m <sup>2</sup>
Total	61.4m <sup>2</sup>

**Architect**  
SJB Architects & SJB Interiors

**Developer**  
Saha Properties

**Scale**  
1:50

**Apartment**  
B709

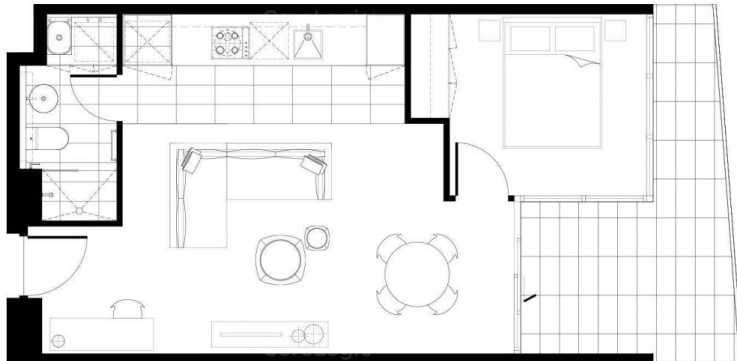

Please note that this floor plan was produced prior to completion of construction and is indicative only and not to scale. Changes may be made during development and dimensions, the layout, finishes and specifications are subject to change without notice in accordance with the provision of the Contract of Sale. The furniture depicted is not included with any sale and should not be taken to indicate the final position of power points, TV connection points and the like. Prospective purchasers must rely on their own enquiries. Bulkheads necessary for services and structure are not depicted.

