





216/631 Victoria Street Abbotsford VIC

2  2  1 

New Park View ParkHouse Apartment

This new two bedroom, two bathroom apartment (with car space) is just a short walk to Victoria Gardens Shopping Centre opposite with Bridge Road/Swan Street eateries and boutiques also close by.

View : <https://www.spaceea.com.au/lease/vic/inner-city/abbotsford/residential/apartment/7375156>

Features include:

- 2 bedrooms with built in robes and master with ensuite
- Sleek central bathroom large bath
- Superior kitchen with Gaggenau Appliances
- Beautiful wide engineered Oak floors
- Two Balconies (total external space = 16.5m²)
- Sustainable 6+ Star Green Living Inside and Out
- Secure Car Space (not stacker) with Storage Cage
- World-Class Resident Amenities
- Exquisite Location on the Banks of the Yarra River

THE
PARKHOUSE
 ABBOTSFORD



KEY

- PA Pantry
- FR Fridge/Freezer
- DW Dishwasher
- WR Wardrobe
- LAU Laundry
- BAL Balcony
- TR Timber Floor
- TL Tile Floor
- CA Carpet



APARTMENT TYPE

G5.1 2 Bed, 2 Bath

AREA

Internal	77.0m ²	828.8ft ²
External	16.5m ²	177.6ft ²
Total	93.5m²	1006.4ft²

APARTMENTS

B214, B216, B314, B414, B416

RESIDENCE



LEVELS

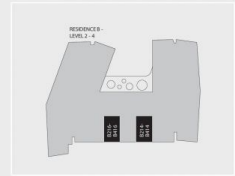

Disclaimer: All images, design features, views, photographs, diagrams and artist's impressions are for presentational purposes and are indicative only. Dimensions, areas, fittings and specifications are indicative and subject to change without notice. All internal/external furniture (including study desks and partner boxes) and fittings are not included in the price. Purchaser should check the plans and specifications in the terms of the contract of sale carefully prior to signing the contract.