

903/627 Victoria Street Abbotsford VIC

1 1 1

CONTACT LUKE ON 0421679021 TO ARRANGE A PRIVATE INSPECTION

View : <https://www.spaceea.com.au/lease/vic/inner-city/abbotsford/residential/apartment/6772284>

With Victoria Gardens Shopping Centre opposite, Bridge Road/Swan Street eateries and boutiques close by, tram on your doorstep to the CBD in 15/20 minutes, The Park House is the ultimate lifestyle choice.

Features:

- 1 Bedroom, 1 Bathroom
- Exquisite Location on the Banks of the Yarra River
- Superior Gaggenau Appliances
- Beautiful wide engineered Oak floors
- Sustainable 6+ Star Green Living Inside and Out
- World-Class Resident Amenities
- Only a 15min tram ride to the Paris-end of Collins St



Luke Connell
0421 679 021

THE
PARKHOUSE
ABBOTSFORD

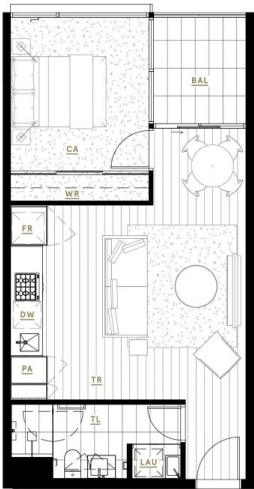

KEY

- PA Pantry
- FR Fridge/Freezer
- DW Dishwasher
- WR Wardrobe
- LAU Laundry
- BAL Balcony
- TR Timber Floor
- TL Tile Floor
- CA Carpet



APARTMENT TYPE

A1.1 1 Bed, 1 Bath

AREA

Internal	50.5m ²	543ft ²
External	5.2m ²	56ft ²
Total	55.7m²	599ft²

APARTMENTS

A302, A303, A402, A403, A502, A503, A602
A603, A702, A703, A802, A803, A902, A903

RESIDENCE



LEVELS

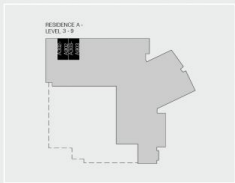

Disclaimer: All images, design features, views, photographs, diagrams and artist's impressions are for presentation purposes and are indicative only. Dimensions, areas, fittings and specifications are indicative and subject to change without notice. All internal/external furniture including study desks and planter boxes and whitegoods are not included in the price. Purchaser should check the plans and specifications in the terms of the contract of sale carefully prior to signing the contract.