



505/35 Wilson Street South Yarra VIC

2 1 1

PLEASE NOTE: Due to current lock-down & government guidelines, entry to advertised open for inspections is limited. You must register to attend or contact the agent listed to arrange a private viewing. Thank you

View : <https://www.spaceea.com.au/lease/vic/inner-city/south-yarra/residential/apartment/5827695>

Fifth Floor North Facing Two Bedroom Apartment featuring:

- Two bedrooms - both with North facing windows and Built In Robes
- Quality kitchen with island bench
- Timber floorboards in the entry, kitchen, meals and living areas
- Built in TV joinery unit
- Concealed air-conditioning
- Secure car space (not stacker) and storage
- Impressive entrance
- Communal rooftop garden and BBQ with city views



Joseph McCurry
03 9257 8788

APARTMENT TYPE 7E

5.05, 6.05, 7.05

2 Bedroom, 1 Bathroom

Total Area 71.4sqm
Apartment Area 63.3sqm
Terrace Area 8.1sqm

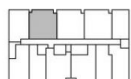

ESSENCE

These plans are intended as a guide only. The dimensions and areas are approximate only and may not accurately represent the actual dimensions and areas of the apartments or the spaces within them and are subject to change without notice. In addition, locations of utilities may vary during construction and fittings and fixtures on these plans are for illustrative purposes only. The areas are generally measured in accordance with the Property Council of Australia method of measurement. Prospective purchasers must rely on their own enquiries and should refer to the Contract of Sale and its schedules for all matters to be included in the purchase price of the apartment, including plans, finishes, fixtures, fittings, appliances and other particulars of sale. Loose furniture and planters are not included. Extent of floor finishes may vary. External space and landscaping indicative only. Refer to level plans for further information.