

G08/12 Wood Street Nunawading VIC

2 1 1

Superior Quality To Create The Ultimate Hub For Your Home.

View : <https://www.spaceea.com.au/lease/vic/east/nunawading/residential/apartment/5827603>

Features include:

- Bright open plan living for practicality and comfort
- Modern kitchen featuring gas cooking and stainless steel appliances
- 2 bedrooms, both with built in robes
- Luxurious ensuite to master bedroom
- Eye catching designer finishes throughout
- Quiet Street frontage and not on a major road
- Stroll to Nunawading station, close proximity to East link
- Adjacent to Wood Park with shops and cafes seconds away
- Moments to Mega Mile shopping outlets such as Brands Smart
- Secure individual basement parking, storage plus internal



Luke Connell
0421 679 021

Ground Floor - Apartment 0-08

INTERIOR: 74 sqm
COURTYARD: 15 sqm
TOTAL AREA: 89 sqm

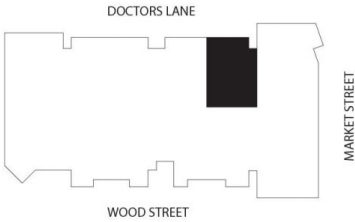
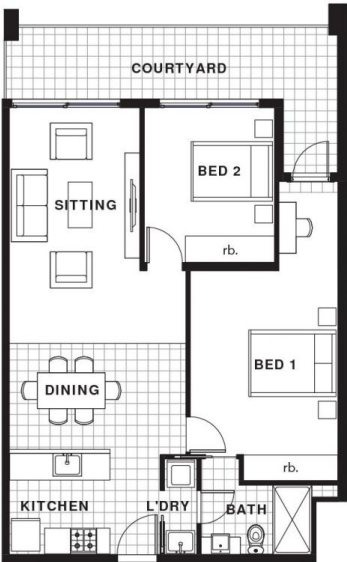

DISCLAIMER

The preliminary plan shows the proposed apartment layout plan for Parkwood Apartments as at the date of issue.
Any furniture shown is illustrative only. It does not constitute any representation by the vendor or its agents nor does it form part of any subsequent contract of sale.
All areas are approximate only and are subject to final survey. Prospective purchasers should make their own enquiries.

