



**603/8 Burnley Street Richmond VIC**

2 2 1

Near new apartment - features include:

- light open-plan living / dining space
- city views over Williams Reserve
- balcony the full width of the apartment
- Smeg-equipped kitchen (gas cook top, electric oven and integrated dishwasher) with island bench
- bathrooms with floor to ceiling tiling
- car space and storage cage
- ground level café
- health and well-being facilities including gym and pool

Moments from Yarra River trails, cycling tracks and city transportation.  
Directly opposite Ikea and Victoria Gardens Shopping Centre.

**View** : <https://www.spaceea.com.au/lease/vic/inner-city/richmond/residential/apartment/5827393>



**Joseph McCurry**  
03 9257 8788



6.03

2 Bedroom  
2 Bathroom

Total Area 90.7sqm  
Apartment Area 73.5sqm  
Terrace Area 17.2sqm

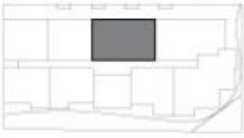

0 2.5m

